

NABCO Automatic Doors

Standard Automatic Door System



Pedestrian Flow Solution



NABCO, Japan No.1 automatic door brand, strives to offer the entire value-chain services to our customers from extensive product lineup, finely tuned sales, installation and to maintenance service. We offer users of all ages, regardless of ability or disability, a more comfortable, safe, and efficient environment by providing optimal solutions tailored to the needs of each situation, under the slogan "Pedestrian Flow Solution."

CONTENTS

Automatic Door Operators

| | | |
|-------------------------------|--|-----|
| Standard Sliding Door | DSN-60 / 75 / 150 / 250 Sliding Door | 3 |
| Heavy Sliding Door | DSN-500 Heavy Sliding Door | 4 |
| Slim Header Sliding Door | DSN-60S / 75S / 150S-HM Slim Header Sliding Door | 4 |
| Telescopic Door | DS-D2 Telescopic Door | 5 |
| Wide-open Door | W0-3 Wide-open Door | 5-6 |
| Circular Door | EU Circular Door | 6 |
| Swing Door | DF-41 Swing Door Operator, GT-710 Power Assist Door Operator | 7 |
| | DH-41 Swing Door Operator | 8 |
| Multipurpose Toilet Door Unit | HDS-4P Multipurpose Toilet Door Unit | 9 |

Complete Door Package

| | | |
|------------------------------|-----------------------|----|
| Hermetic / Sound Proof Door | Hermetic Door NAX | 10 |
| Folding Door / Gliding Door | Mini Fold, Mini Glide | 11 |
| LOSCA Door (Slim & Eco Door) | LOSCA II, LOSCA A | 12 |

Others

| | | |
|-------------|---|----|
| Information | Cautions for safe operation when using automatic door | 13 |
| About NABCO | About NABCO | 14 |

Function represented by the icon

Location



Only for outdoor use



Only for indoor use



For outdoor and indoor use

Function



Energy Saving



Hermetic



Sound Proof



Barrier Free



NABCO
Network System

Door Operator

DSN-60/75/150/250 Sliding Door



Adaptable to a wide range of customer requirements from lightweight to middleweight doors

- Network technology using CAN communication is adopted between automatic door devices.
- Advanced design is employed to balance high-performance and downsizing.
- Durable brushless DC motors achieve an adequate power margin and smooth passage.
- The door motor incorporates a thermal protector for motors and is thoughtfully designed so as not to stop the door abruptly.



| Door Type | Single | | | | | Bi-Parting | | | | |
|--|---------------------------------|---------|---------|-----------|----------------------------------|---------------------------------|--------|---------|------------|----------------------------------|
| Door Operator Type | DSN-60 | DSN-75 | DSN-150 | | DSN-250 | DSN-60 | DSN-75 | DSN-150 | | DSN-250 |
| Applicable Door Mass x Door Qty (kg) | 75 x 1 | 100 x 1 | 120 x 1 | 150 x 1*2 | 250 x 1 | 60 x 2 | 85 x 2 | 120 x 2 | 150 x 2 *2 | 250 x 2 |
| Applicable Door Area : DW×DH (m²) | 2.2 | 2.8 | 3.3 | | 9.3 | 1.8 | 2.6 | 3.0 | | 5.0 |
| Applicable Door Width : DW (mm) | 650～2500 | | | | 1200～3100 | 650～2500 | | | | 900～2705 |
| Ratio of Door Height / Width : DH / DW | Max. 4.0 | | | | Max. 3.0 | Max. 4.0 | | | | Max. 3.0 |
| Power Supply | 100V AC ± 10%, 50 / 60Hz, 5A | | | | 100V AC ± 10%, 50 / 60Hz, 10A | 100V AC ± 10%, 50 / 60Hz, 5A | | | | 100V AC ± 10%, 50 / 60Hz, 10A |
| Door Operation Speed (m/sec) | 0.1 - 0.7 *1 | | | | | 0.1 - 0.7 *1 | | | | |
| Wind Load (m/sec) | 15 | | | | | 15 | | | | |

*1 The speed varies according to the door weight or operating environment. *2 Only for DSN-150 F15

Dimension(mm)

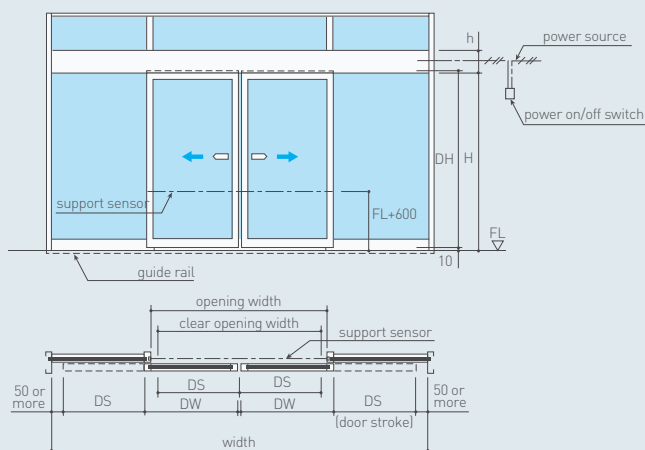

Concealed side mount for Aluminum sash

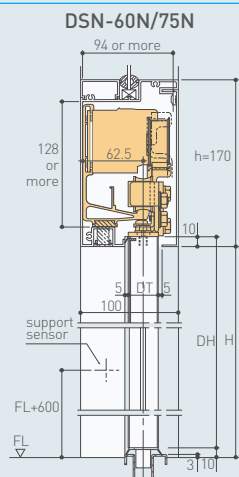

Concealed flat bar mount for Stainless steel sash

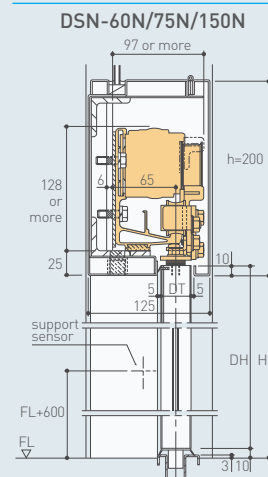

Surface mount

DSN-60S/75S/150S

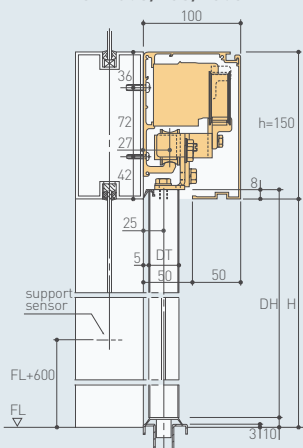

Concealed flat bar mount for Stainless steel sash

DSN-75F/150F12/150F15

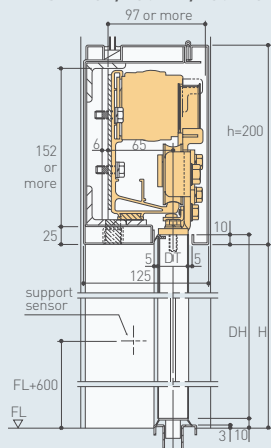

Concealed flat bar mount for Stainless steel sash

DSN-250

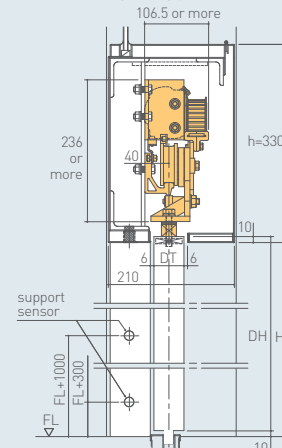

Door Operator

DSN-500 Heavy Sliding Door



Available to large sized or heavy duty industrial doors

- Suitable for bi-parting doors of up to 500 kg per door and single sliding doors of up to 1000 kg
- Auxiliary reduction gears enable the operation of doors up to 2000 kg (single sliding)

Dimension(mm)

Concealed flat bar mount
for Stainless steel sash

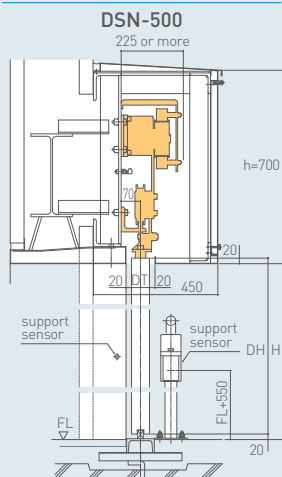

| Door Type | Single | Bi-Parting |
|--|-------------|-------------|
| Door Operator Type | DSN-500 | DSN-500 |
| Applicable Door Mass x Door Qty (kg) | 1000 x 1 | 500 x 2 |
| Applicable Door Area : DW×DH (m²) | 27.5 | 14 |
| Applicable Door Width : DW (mm) | 6100 | 3100 |
| Ratio of Door Height / Width : DH / DW | Max. 3.0 | Max. 3.0 |
| Power Supply | 200VAC · 6A | 200VAC · 6A |
| Door Operation Speed (m/sec) | 0.1-0.5 *1 | 0.1-0.5 *1 |
| Wind Load (m/sec) | 15 | 15 |

*1 The speed varies according to the door weight or operating environment.

Door Operator

DSN-60 / 75 / 150S-HM Slim Header Sliding Door



Aesthetic slim design which enhances the value of your entrance

- Slim design:
Height of the header is only 100mm, and can be integrated to the design of various entrances such as office building, shopping mall, etc.
- High performance:
NET-DS series is adopted as an operating unit which provides a high level of safety and reliability with optimal functionality.



| Door Type | Single | | | Bi-Parting | | |
|--|---------------------------------|--------|---------|------------|--------|---------|
| Door Operator Type | DSN-60 | DSN-75 | DSN-150 | DSN-60 | DSN-75 | DSN-150 |
| Applicable Door Mass x Door Qty (kg) | 75 | 100 | 120 | 60 × 2 | 85 × 2 | 120 × 2 |
| Applicable Door Area : DW×DH (m²) | 2.2 | 2.8 | 3.3 | 1.8 | 2.6 | 3.0 |
| Applicable Door Width : DW (mm) | 650 ~ 1250 | | | | | |
| Ratio of Door Height / Width : DH / DW | Max. 4.0 | | | | | |
| Door Operation Speed (m/sec) | 0.1-0.7*1 | | | | | |
| Power Supply | 100V AC ± 10%, 50 / 60Hz, 5A | | | | | |
| Wind Load (m/sec) | 15 | | | | | |

*1 The speed varies according to the door weight or operating environment.

Dimension(mm)

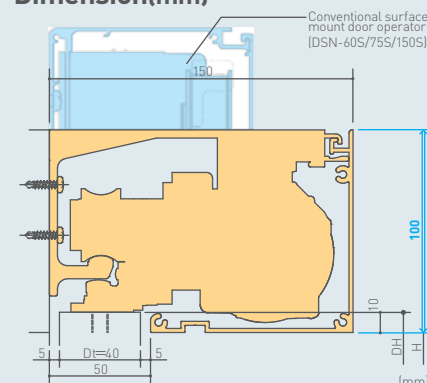

Door Operator

DS-D2 Telescopic Door



Even when the frontage is narrow, the door opening is as wide as possible.

- Even when the frontage is narrow, a wide door opening is provided (1.3 times wider than usual sliding doors).



| Door Type | Single | | | Bi-Parting | | |
|--|-----------------------------|-----------|------------|------------|-----------|------------|
| Door Operator Type | DSN-60*1 | DSN-75 | DSN-150 | DSN-60*1 | DSN-75 | DSN-150 |
| Applicable Door Mass x Door Qty (kg) | 50 x 2 | 65 x 2 | 100 x 2 | 40 x 4 | 55 x 4 | 100 x 4 |
| Applicable Door Area : DW×DH (m²) | 1.6 | 2.1 | 2.4 | 1.4 | 1.9 | 2.2 |
| Applicable Door Width : DW (mm) | 500-600*2 | 500-800*2 | 500-1000*2 | 500-550*2 | 500-650*2 | 500-1000*2 |
| Ratio of Door Height / Width : DH / DW | Max. 4.2 | | | | | |
| Power Supply | 100VAC ± 10%, 50 / 60Hz, 5A | | | | | |
| Door Operation Speed (m/sec) | 0.1~0.7*3 | | | 0.1~0.7*3 | | |
| Wind Load (m/sec) | 15 | | | | | |

*1 Indoor use only

*2 When applying to Framed Door

*3 The speed varies according to the door weight or operating environment.

Dimension(mm)

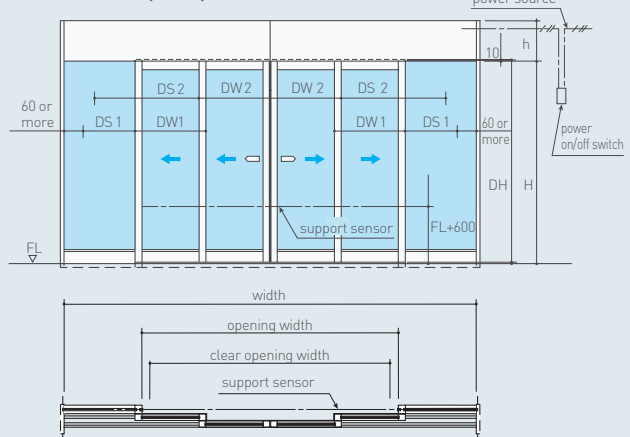

Surface mount

Concealed flat bar mount

DS-D2S

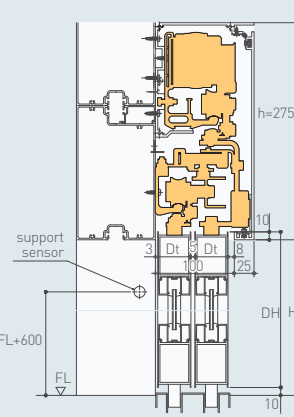

DS-D2

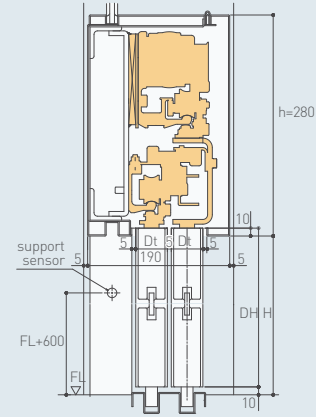

Door Operator

WO-3 Wide-open Door

The automatic sliding door fully opens twice as wide as usual sliding doors

- After the sliding door is opened, it manually swings open twice as wide as usual.

| Door Operator Type | WO-3 | | | |
|-------------------------------------|------------------------------|------------|---------------------|------------|
| Door Type | Bi-Parting | | Single | |
| Applicable Door Massx Door Qty (kg) | 120×2 | | 120×1 | |
| Sash Material | Stainless steel SUS304/Steel | | | |
| Door Type | Tempered glass door | Frame door | Tempered glass door | Frame door |
| Sash Width: W (mm) | 4786 | 4800 | 2394 | 2400 |
| Sash Height: H (mm) | 2454 | 2400 | 2454 | 2400 |
| Sash Depth: (mm) | 165 | | | |
| Height of Transom: H (mm) | 290 | | | |
| Depth of Transom: (mm) | 155 | | | |
| Applicable Door Width : DW (mm) | 1219 | 1231 | 1219 | 1231 |
| Applicable Door Hight : DH(mm) | 2438 | 2348 | 2438 | 2348 |
| Door Thickness : DT (mm) | 28 | 46 | 28 | 46 |
| Clear Opening at Sliding (mm) | 2112 | 2010 | 1057 | 1005 |
| Clear Opening at Wide Open (mm) | 4422 | 4322 | 2212 | 2161 |
| Door Operation Speed (m/sec) | 0.1-0.7 *1 | | | |
| Power Supply | 100V AC・5A | | | |

*1 The speed varies according to the door weight or operating environment.



EU Circular Door



Beautiful curved surface in design

- The door offers a large choice of radiuses, from 1200 mm.
- The ultrasonic support sensor enhances safety in the doorway area.



The National Museum of Art, OSAKA

| Door Type | Single | | Bi-Parting | |
|--|----------------------------------|---------|------------|---------|
| Door Operator Type | DSN-75 | DSN-150 | DSN-75 | DSN-150 |
| Applicable Door Mass x Door Qty (kg) | 75 x 1 | 100 x 1 | 75 x 2 | 100 x 2 |
| Applicable Door Width : DW (mm) | 762 ~ 1067 *1 | | | |
| Applicable Door Height : DH (mm) | Max. 2438 *1 | | | |
| Ratio of Door Height / Width : DH / DW | Max. 3.0 | | | |
| Power Supply | 100V AC \pm 10%, 50 / 60Hz, 5A | | | |
| Door Operation Speed (m/sec) | 0.1 ~ 0.7 *3 | | | |
| Wind Load (m/sec) | 10 | | | |

*1 When applying to Tempered glass Door

*3 The speed varies according to the door weight or operating environment.

Dimension(mm)

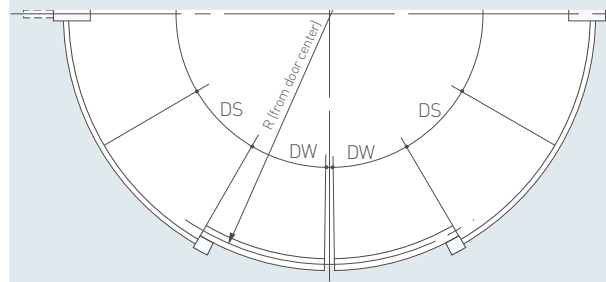

Concealed flat bar mount

EU

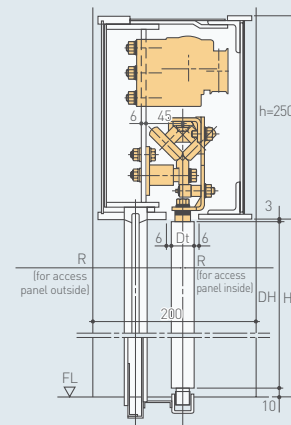

Dimension(mm)

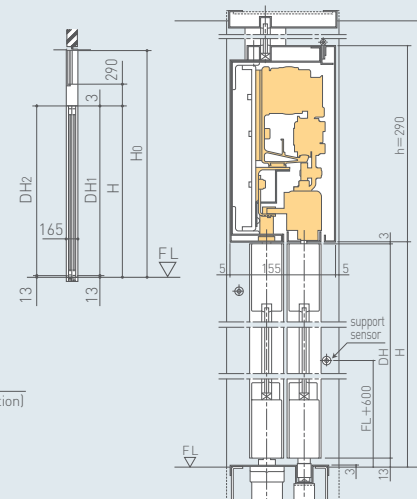
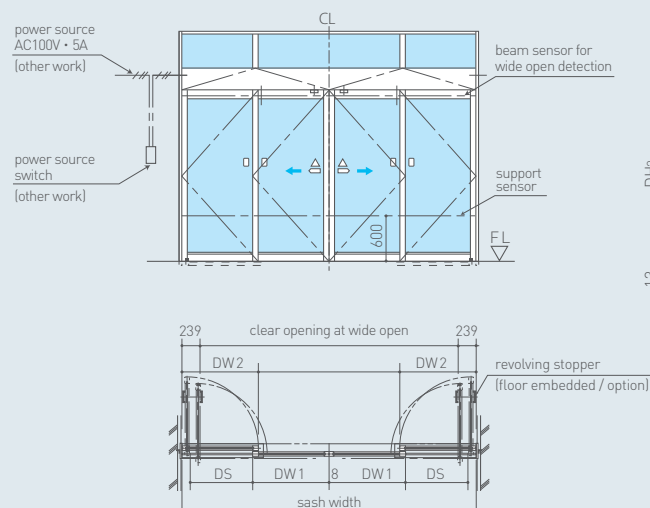

(mm)



Door Operator

DF-41 Swing Door

Offering a unique entrance design

- Outward and inward-opening doors are available.
- The controller is separated from the open / close operation unit and mounted on the wall.
- When the door is a bi-parting type, both doors are operated in synchronization.



Dimension(mm)

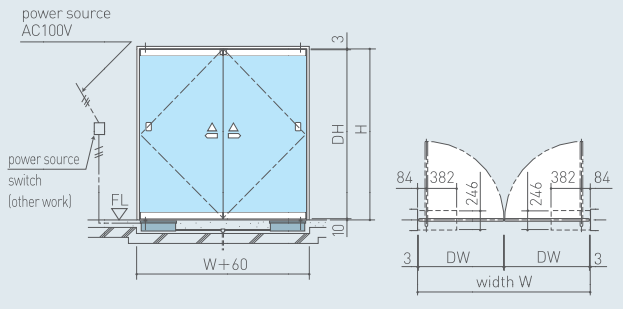

Table

Max. inertia moment of applicable door
The relation of door width and mass

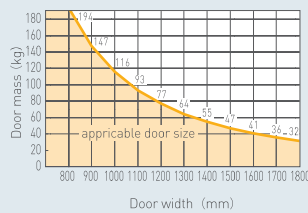

The relation of door width and door height
when receiving resistance torque caused by wind pressure

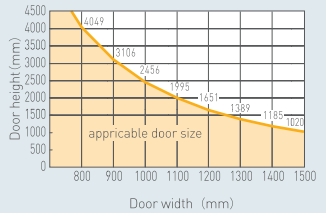

| Door Operator Type | DF-41 | |
|--|-------------------------|--------------|
| Door Type | Double-swing | Single-swing |
| Applicable Door Massx Door Qty (kg) | 110×2 | 110×1 |
| Applicable Door Area : DW×DH (㎡) | Please refer to "Table" | |
| Applicable Door Width : DW (mm) | 700~[Reference: Table] | |
| Average Door Operation Speed (degrees/sec) | 45° or less | |
| Power Supply | 100V AC・10A | 100V AC・5A |
| Wind Load (m / sec) | 10 | |

Door Operator

GT-710 Power Assist Door

User-friendly indoor door opened with a light touch

- The door is automatically opened in the full position with a light push (pull).
- The door remains open for a time after the hand is removed, which is convenient for wheelchair users.
- When the door is difficult to pull, it can be opened by a nearby activation switch.
- In a power failure, the door can be manually opened easily and then automatically closed.
- The controller can be easily attached to existing manual swing doors.

| Door Operator Type | GT-710C (×2) | GT-710C (×1) |
|--|---------------------------------|--------------|
| Door Type | Double-swing | Single-swing |
| Applicable Door Massx Door Qty (kg) | 90×2 | 90×1 |
| Applicable Door Area : DW×DH (㎡) | 2.6 | |
| Applicable Door Width : DW (mm) | 838~1219 | |
| Door Thickness | 30~50 | |
| Operation At Power Failure | Manual open and automatic close | |
| Operator Dimension | W880 (Standard) ×H158×D147 | |
| Operator Box Color | Silver or Dark bronze | |
| Average Door Operation Speed (degrees/sec) | 35° or less | |
| Power Supply | 100V AC・10A | 100V AC・5A |



DH-41 Swing Door

Pleasing openness for inviting guests

- The unit automatically adjusts the driving force to achieve a consistent operating feel, regardless of door weight or external force, such as air pressure.
- In the case of bi-parting type with two door motors, both right and left doors are automatically operated in synchronization.
- The door is applicable to the overlapping structure of door ends (order adjusting function).



Table

□ Double-swing (Door operator x1)
 ■ Single-swing (Door operator x2)

Max. inertia moment of applicable door
 The relation of door width and mass

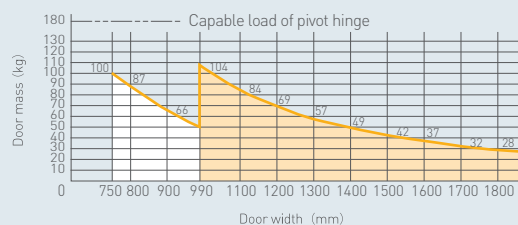

The relation of door width and door height when receiving resistance torque caused by wind pressure

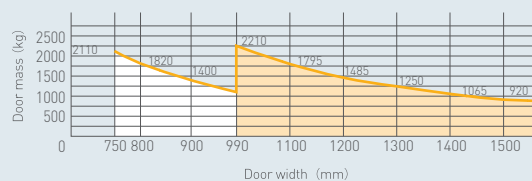

| Door Operator Type | DH-41 (×1) | DH-41 (×2) | DH-41 (×1) |
|---|--------------------------|------------------------|------------------------|
| Door Type | Double-swing | Double-swing | Single-swing |
| Applicable Door Massx Door Qty (kg) | 100×2 | 104×2 | 104×1 |
| Applicable Door Area : DW×DH(m ²) | Pleaser refer to "Table" | | |
| Applicable Door Width : DW (mm) | 750~990 | 990~(Reference: Table) | 990~(Reference: Table) |
| Average Door Operation Speed (degrees/sec) | 45° or less | | |
| Power Supply | 100V AC・10A | | 100V AC・5A |
| Wind Load (m / sec) | 10 | | |



Dimension(mm)

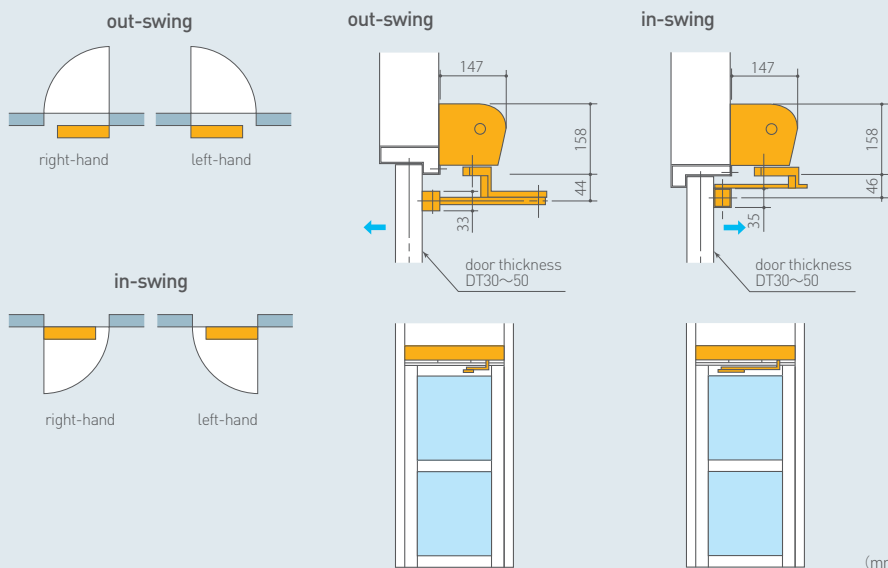

Door Operator

Multipurpose Toilet Door Unit



Accessible toilet for wheel chair users or baby carriage users

HDS-4P Push Button Switch

Universally designed door operation switch for public toilets achieves both harmony with toilet space and usability.

- Guidance by illumination
 - The button to be pushed next lights up
 - Pushing button makes beep sound for confirmation of operation.
- Due consideration for visual impediment
 - Due consideration for the visually impaired people
 - Higher visibility for people with red-green color vision deficiency
- Due consideration to people in wheelchairs and the elderly
- Audio guidance is available(English/Japanese/Chinese/Korean)

| | |
|------------------|--|
| Detection Method | Pressure detection (Push-button type) |
| Operation Force | Approx. 5N |
| Indicator Light | White LED |
| | Stand-by: Off Occupied: On |
| Installation | Embedded in the wall ※Option: exposed on the wall |



Inside switch



Outside switch



Dimension(mm)

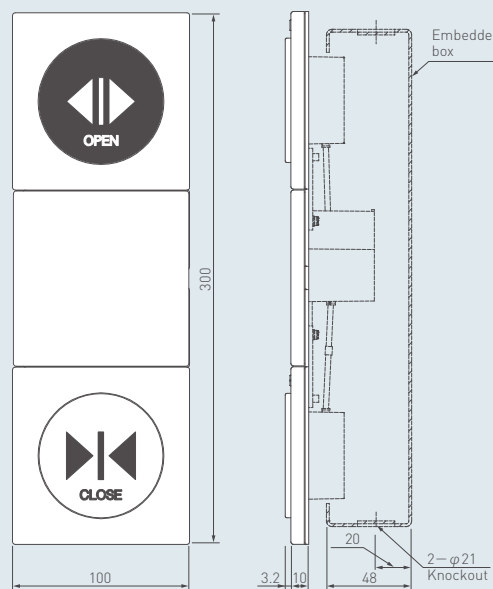

Dimension of Multipurpose Toilet Door Unit (mm)

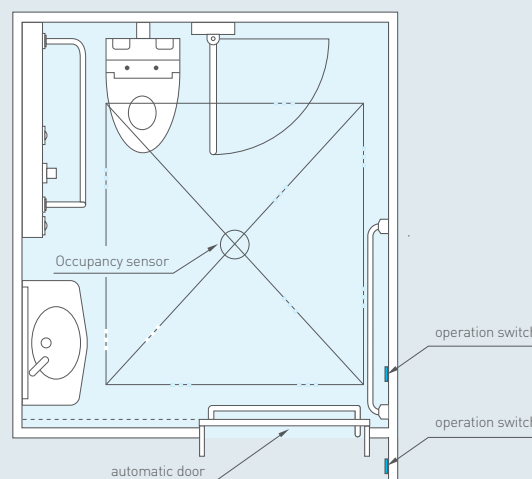
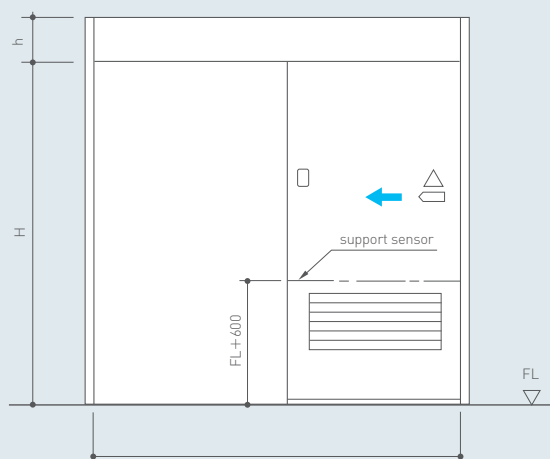

Hermetic Door NAX

Provides high air tightness, aesthetic and safety.

- Air Tightness :
High class of air tightness
【EU】 BS EN12207 : Class 4
【JAPAN】 JIS A4702 : ClassA-4
- Aesthetic :
-Smallest header size in the industry
-Wide range of door leaves and handle
- Safety :
-Possible to be fully opened without any clearance left
-Easy to open manually in case of a power failure



● Specification

| Use Applications | | Air tightness + Sound insulation | | Air tightness + Sound insulation + X-ray shield | |
|---------------------------------|------------|---|-------------|--|-----------------|
| Door Leaf | | Aluminum / Stainless steel / Glass | | Aluminum | Stainless steel |
| Door Type | | Single | Bi parting | Single | Single |
| Clear Opening (mm) | Width (W) | 700 - 2000 | 1200 - 2800 | 700 - 1600 | 700 - 1100 |
| | Height (H) | 1900 - 2500 | 1900 - 2500 | 1900 - 2500 | 1900 - 2500 |
| Max Weight | | 150kg | | | |
| Opening Operation Speed (m/sec) | | 0.1-0.7*1 | | | |
| Hold Open Time | | adjustable | | | |
| Ambient Temperature | | -10°C to 50°C | | | |
| Power Supply | | 230VAC +6/-10% 50/60Hz*2 | | | |
| Power Consumption | | 45Wh | | | |
| Relative Humidity | | 20% to 85% RH | | | |
| Air Permeability | | Class 4 (BS EN12207)*3 A-4 (JIS A 4702) | | | |
| Sound Insulation | | T-1 (JIS A 4702)*4 | | T-1 (JIS A 4702) | |
| X-ray Shield | | — | | ○ (Lead plate 2mm) | |
| Electric Lock | | | | ○ | |

*1 The speed varies according to the door weight or operating environment.

*2 With transformer specified by NABCO

*3 Class 4 (BS EN12207) is applicable to single sliding door only.

*4 The type of glass door leaf has T-2 class of sound insulation. If T-2 class is required for aluminum/stainless door leaf, please contact our sales distributor.

Dimension(mm)

Elevation

【Stainless steel】There is a joint line when the door width is over 1100.

【Aluminum】There is a joint line when the door width is over 1400.

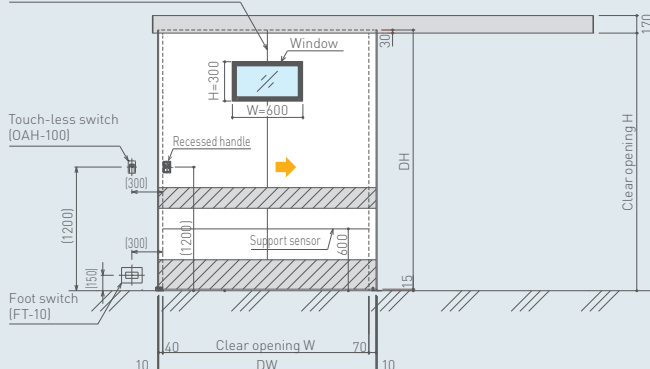

Unit: mm

Section

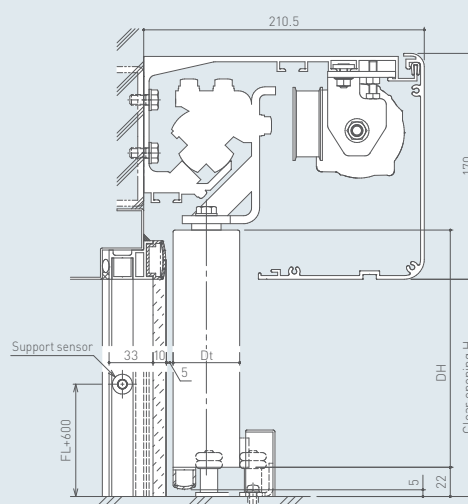

*The section shows when the door is fully opened

*Handle, waist plate, kick plate and lock are optional

Mini Fold / Mini Glide / LOSCA Door II / LOSCA A

Door Package

Mini Fold



GOOD DESIGN AWARD 2001
**LONG LIFE
DESIGN AWARD**



Small automatic folding door to make the best use of a limited space

- Achieving such a smooth operation as a sliding door, the door provides comfortable passage.
- The folding door can open widely in a limited space and does not need door pockets.
- The pinch guard structure around the door hinge enhances safety.



| Door Type | 4 leaves | 2 leaves |
|--|---|----------|
| Applicable Door Width : DW (mm) | 1000~1800 | |
| Applicable Door Height : DH (mm) | 2400 or less | |
| Applicable Entrance Height w / o Fanlight (mm) | H +170 | |
| Applicable Entrance Height with Fanlight (mm) | 4000 or less | |
| Frame Depth (mm) | 100 | |
| Operator Box Size HW (mm) | 100×170 | |
| Frame / Door Material | Aluminum (White / Black / Silver / Bronze / Stainless) | |
| | Stainless steel (Hair line finish / Mirror finish) | |
| Applicable Glass Thickness (mm) | 3, 4, 5, 6, 6.8 (wired glass) | |
| Average Door Operation Speed (m / sec) | 0.4 or less | |
| Power Supply | 100V AC · 5A | |
| Wind Load (m / sec) | 10 (for outdoor use) 7 (for interior use) | |

Dimension(mm)

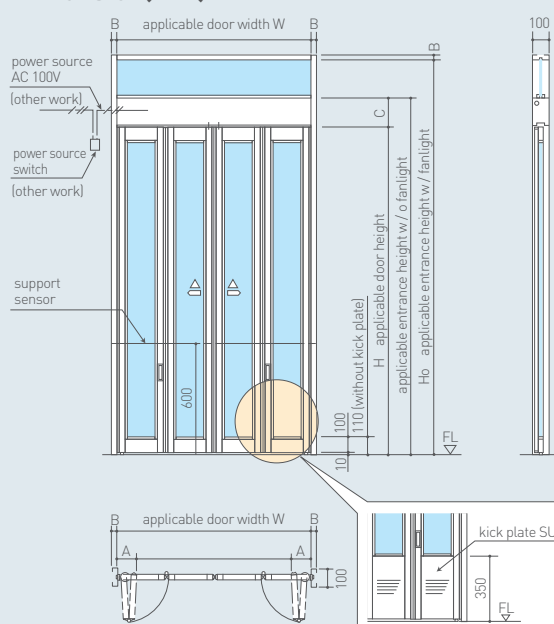

| | A | B | C |
|----------------|---------|----|-----|
| aluminum sash | 120~130 | 30 | 170 |
| stainless sash | 140 | 30 | 200 |

Door Package

Mini Glide



GOOD
DESIGN



Small automatic gliding door that has limited opening space but enables smooth passage

- The motion of the door, which does not disturb the flow of people, offers comfortable passage in a narrow corridor.
- The simple appearance like a swing door provides a feeling of serenity.
- Barrier-free without guide rail can be selectable for indoor use.



| Door Type | Double glide | Single glide |
|--|---|--------------|
| Applicable Door Width : DW (mm) | 1000~1800 | 800~900 |
| Applicable Door Height : DH (mm) | 2400 or less | |
| Applicable Entrance Height w / o Fanlight (mm) | H +170 | |
| Applicable Entrance Height with Fanlight (mm) | 4000 or less | |
| Frame Depth (mm) | 100 | |
| Operator Box Size HW (mm) | 100×170 | |
| Frame / Door Material | Aluminum (White / Black / Silver / Bronze / Stainless) | |
| | Stainless steel (Hair line finish / Mirror finish) | |
| Applicable Glass Thickness (mm) | 3, 4, 5, 6, 6.8 (wired glass) | |
| Average Door Operation Speed (m / sec) | 0.4 or less | |
| Power Supply | 100V AC · 5A | |
| Wind Load (m / sec) | 10 (for outdoor use) 7 (for interior use) | |

Dimension(mm)

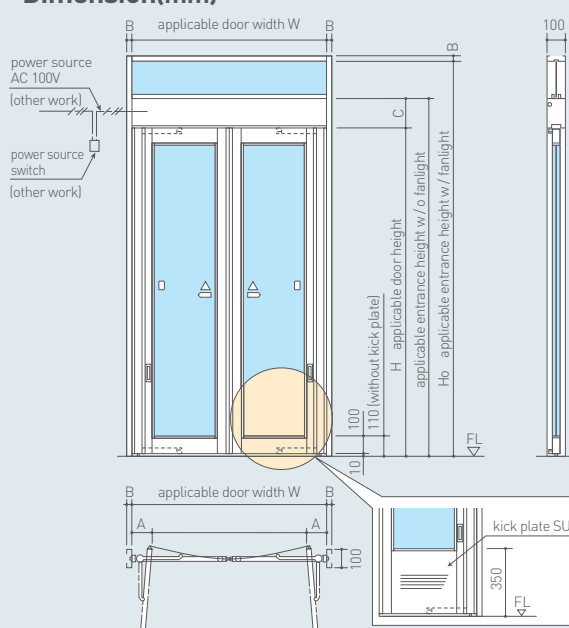

| | A | B | C |
|----------------|---------|----|-----|
| aluminum sash | 132~157 | 30 | 170 |
| stainless sash | 141~162 | 30 | 200 |

LOSCA II Slim & Eco Door



GOOD DESIGN AWARD 2001
LONG LIFE
DESIGN AWARD



Elegant appearance of a slim stainless steel frame

- The adoption of tempered glass with 8 mm thickness significantly reduces the weight.
- Compatibility with popular tempered glass doors makes it easy to replace the door.
- The glass protection structure improves safety.

| Glass Thickness (mm) | 8 | 12 |
|----------------------------------|---|-----------|
| Applicable Door Width : DW (mm) | 500~1100 | 500~1250 |
| Applicable Door Height : DH (mm) | 1700~2500 | 1700~2700 |
| Standard Glass | Transparent tempered glass | |
| Frame : Standard Frame | Stainless SUS-304 with hairline / mirror / vibration finish | |



Dimension(mm)

Elevation

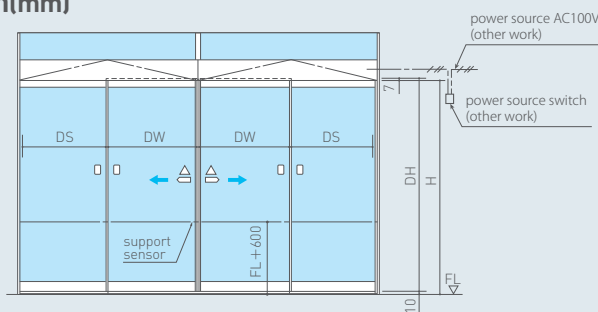

Section

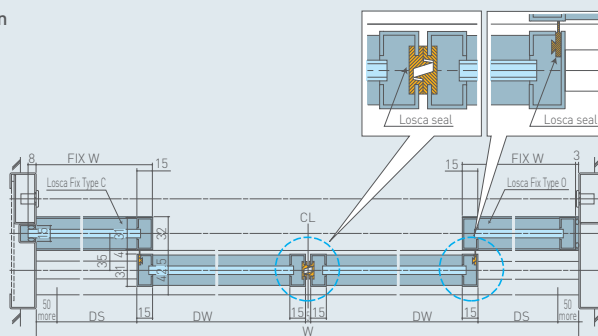

Section

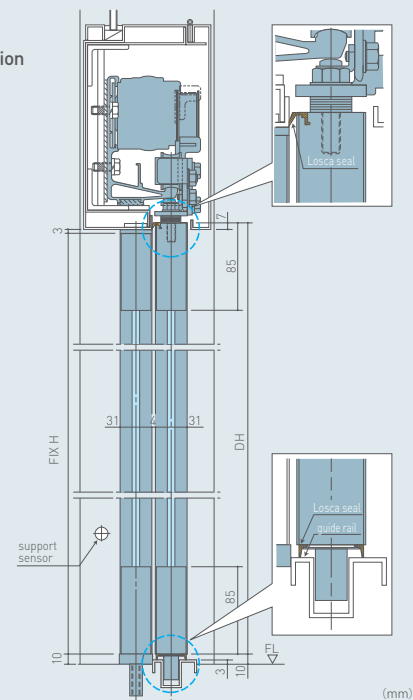

LOSCA A Slim & Eco Door



Lightweight LOSCA door with aluminum steel frame

- Compatibility with popular tempered glass doors makes it easy to replace the door.
- The glass protection structure improves safety.
- Losca A40, which is compatible with a frame door of 40 mm in thickness, is also available.

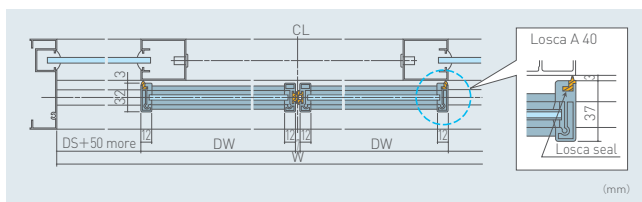

| Glass Thickness (mm) | 6 | 8 | 12 |
|----------------------------------|--|-----------|-----------|
| Applicable Door Width : DW (mm) | 500~1000 | 500~1200 | 500~1250 |
| Applicable Door Height : DH (mm) | 1700~2200 | 1700~2500 | 1700~2700 |
| Standard Glass | Transparent tempered glass | | |
| Frame : Standard Frame | Aluminum frame : black / stainless / bronze / white / silver | | |

Cautions

For safe operation when using automatic doors

1. Don't halt !

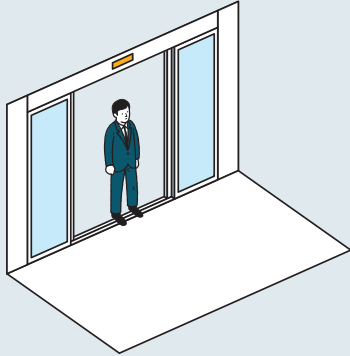

Do not stop on the door way.

2. Don't run in !



Do not rush through the door.
Do not cross the door diagonally.

3. Don't play near automatic door !



Do not stand talking near the door.
Do not let children play near the door.

4. Don't lean on the automatic door !



Do not lean on the door, the screen or the wall
nearby nor step on them.

5. Accompany your children !



For small children, grownups should take
their hands when passing through the door.
Extra care should be taken for the handicapped
and blind persons in going through the door.

6. Pay attention to the door !

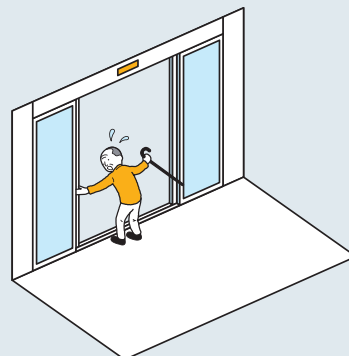

Be careful so that fingers will not be caught in
the leading or rear edge of the door.

About NABCO

As the No.1 automatic door brand in Japan

NABCO manufactured the first automatic door in Japan and it has No.1 share in Japan over the years. NABCO is now the major automatic door manufacturer in the world.

Since NABCO manufactured the first automatic door in Japan in the 1950s, we have developed a vast range of products for different applications and provided best services to our customers, which has made NABCO the “Only One” automatic door solution provider.

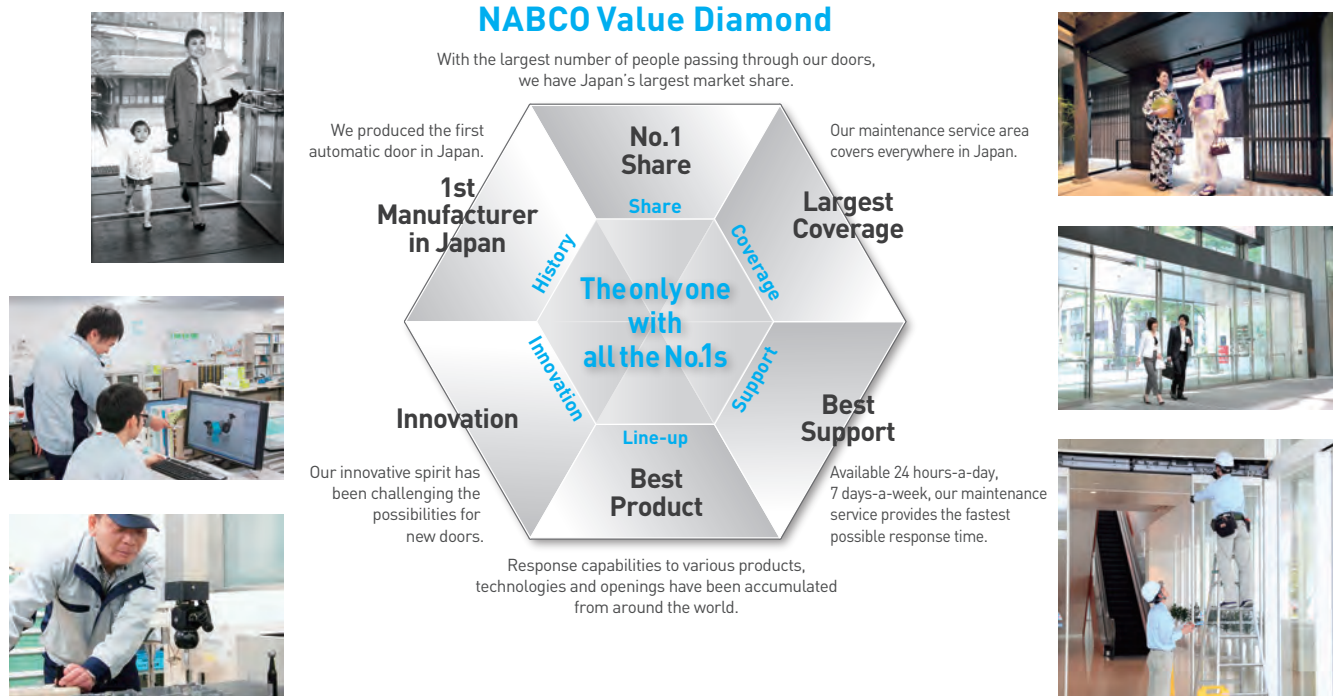

Global Business

NABCO has started its overseas business since the 1960s. Since then, our business has extended to various countries. In the healthcare field, NABCO has been providing premium entrance systems and services and earned a reputation from our customers around the world.





Nabtesco Corporation

Accessibility Innovations Company

Address : JA Kyosai Bldg., 7-9,
Hirakawacho 2-chome,
Chiyoda-ku, Tokyo,
102-0093, Japan

Phone : +81(0)3-5213-1157
Fax : +81(0)3-5213-1173



ISO9001 • ISO14001 Certified



For further details, please contact:

<https://nabco.nabtesco.com/en/>

All specifications herein are subject to change without notice

CAT.No. D685 1603 1811 02RI