

C160 RWA DOUBLE CHAIN



Dual push points chain actuator
 Thrust force max. 600N
 Stroke 360mm - 600mm

PRODUCT DESCRIPTION

Electric actuator Topp model C160 RWA with 2 double-link chains, in an elegant die-cast aluminium profile, complete with brackets and accessories for bottom hung windows outward opening for smoke evacuation application. Operation at 24V DC. Max. thrust force 300N. Stroke 360 - 600 mm. Electronic end of stroke in closing by current absorption control.

CE marked device, tested in accordance with the EN12101-2 Standard for smoke ventilation applications.



Tailored profile lengths according to the window frame width. (International patent)

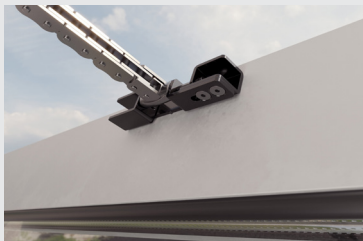

Special hooking of chain to window to guarantee very high resistance with a long stroke even on top hung windows.



Innovatory and original design.



TECHNICAL SPECIFICATIONS

	C160 RWA double chain stroke 360 mm	C160 RWA double chain stroke 600 mm
Power supply voltage	24V d.c.	24V d.c.
Max applicable load in thrust	400N	600N
Max applicable load in traction	300N	600N
Stroke	360mm	600mm
Absorbed current	0,75A	2,10A
Idle translation speed	7,5 mm/sec	13 mm/sec
Duration of the idle stroke	48s	45s
Service type	S2 of 4min	S2 of 4min
Operating temperature	-15°C + 50°C	-15° + 50°C
Protection Class	IP30	IP30
Stroke end regulation in closure	not necessary	not necessary
Parallel connection option	YES	YES
Stroke end	Electronic in opening, by amperometric absorption in closing	



Stroke
360mm

Stroke
600mm

C160 RWA dual push point (from 1200mm to 1500mm)

C160 24V RWA dual push point for bottom-hung (outwards opening)	3E12#	
C160 24V RWA dual push point for bottom-hung (inwards opening)	3E12#	
C160 24V RWA dual push point for top-hung application*	3E12#	
C160 24V RWA dual push point for outward swinging application	3E12#	
C160 24V RWA dual push point for inward swinging application	3E12#	

C160 RWA dual push point (from 1510mm to 2000mm)

C160 24V RWA dual push point for bottom-hung (outwards opening)	3E12#	3E11#
C160 24V RWA dual push point for bottom-hung (inwards opening)	3E12#	3E11#
C160 24V RWA dual push point for top-hung application*	3E12#	3E11#
C160 24V RWA dual push point for outward swinging application	3E12#	3E11#
C160 24V RWA dual push point for inward swinging application	3E12#	3E11#

C160 RWA dual push point (from 2010mm to 2500mm)

C160 24V RWA dual push point for bottom-hung (outwards opening)	3E12#	3E11#
C160 24V RWA dual push point for bottom-hung (inwards opening)	3E12#	3E11#
C160 24V RWA dual push point for top-hung application*	3E12#	3E11#
C160 24V RWA dual push point for outward swinging application	3E12#	3E11#
C160 24V RWA dual push point for inward swinging application	3E12#	3E11#

C160 RWA dual push point (from 2510mm to 3000mm)

C160 24V RWA dual push point for bottom-hung (outwards opening)	3E12#	3E11#
C160 24V RWA dual push point for bottom-hung (inwards opening)	3E12#	3E11#
C160 24V RWA dual push point for top-hung application*	3E12#	3E11#
C160 24V RWA dual push point for outward swinging application	3E12#	3E11#
C160 24V RWA dual push point for inward swinging application	3E12#	3E11#

C160 RWA dual push point (from 3010mm to 4000mm)

C160 24V RWA dual push point for bottom-hung (outwards opening)	3E12#	3E11#
C160 24V RWA dual push point for bottom-hung (inwards opening)	3E12#	3E11#
C160 24V RWA dual push point for top-hung application*	3E12#	3E11#
C160 24V RWA dual push point for outward swinging application	3E12#	3E11#
C160 24V RWA dual push point for inward swinging application	3E12#	3E11#

*CS1 chain anti-closing accessories for top-hung application (2pcs) included.

Description for dual push point solution bottom-hung outward opening application (from 1510mm to 2000mm)

3E11#	C160 24V RWA dual push point chain actuator stroke 600mm Bracket for bottom-hung outward opening application (window opening min 1500mm) for C160 dual push point (2pz) Clamps for top hung and bottom hung outwards opening windows for C160 dual push point (2pz) Iron hooking device for top/bottom hung outwards opening for C160 stroke 600 and 1000 mm (2pz)
-------	---

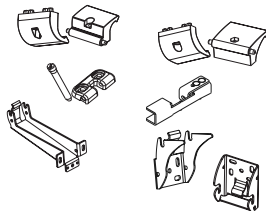

Accessories and spare parts

3A5005	Clamps for top hung and bottom hung outwards opening windows
3A5006	Clamps for bottom hung windows
3A5051	Hooking device for top/bottom hung (outwards opening) for C160 RWA double chain stroke 360mm
3E3100	Iron hooking device for top-hung and bottom hung outwards opening for C160 stroke 600 mm
1A5800	Bottom-hung bracket
1A5832	Bracket for bottom hung application for C160 dual push point
1A5831	Bracket for bottom-hung outward opening application for C160 dual push point

